

PAM GLOBAL PLUS

Short single branch 45°



DESCRIPTION

Part of the Specialized Plus range, the PAM GLOBAL Plus single branche allows the junction between two pipe runs at a 45° angle for conveying hot and/or aggressive wastewater fluid. Designed for intensive use, the cast iron epoxy coated fittings are indefinitely recyclable.

Material & Coatings

- Cast Iron
- Coating: grey RAL 7015, epoxy, average dry film thickness 300 µm.

RECOMMENDED USE

- Aggressive effluents
- Corrosive atmosphere
- Fat Wastewater
- Hot effluents
- Industrial Wastewater

TECHNICAL FEATURES

- Hot water resistance: 24h at 95°C.
- Thermal cycle resistance: 1500 cycles between 15°C and 93°C.
- Chemical resistance for $2 \leq \text{pH} \leq 13$, up to 80°C.
- Salt spray resistance: 1500h.

STANDARDS & APPROVALS

- Industry Product Standards: EN 877, CE, DIN 19522, GEG RAL-GZ 698
- Range acoustic performance: $L_{sc,A} < 10 \text{ dB(A)}$ & $L_{a,A} = 47 \text{ dB(A)}$ according to EN 14366 with 2 l/s.
- Range reaction to fire: Euroclass A2-s1,d0

ENVIRONMENTAL DATA

- Percentage of Recycled Content: 99.0 %
- Recycling Information: Cast iron is fully recyclable through the existing recycling industrial network.
Data source: Environmental Product Declaration S-P-02013

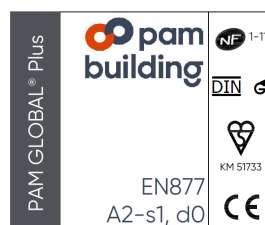

PAM GLOBAL PLUS

Short single branch 45°

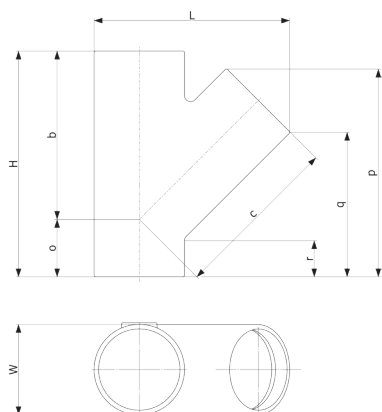

DN	dn	L	H	W	b	c	o	p	q	r	Weight	Product Code
50	50	144	185	58	135	135	50	165	124	36	1.35	155213
75	50	156	180	83	135	135	45	161	120	43	1.6	176740
75	75	179	215	83	155	155	60	198	140	40	2.2	176742
100	50	191	200	110	165	165	35	172	131	47	2.4	155245
100	75	214	235	110	185	185	50	209	150	44	3.2	176743
100	100	238	275	110	205	205	70	253	175	45	4.0	155255
125	50	218	205	135	185	185	20	170	130	44	3.2	155264
125	75	237	240	135	195	200	45	215	156	51	4.2	176784
125	100	261	280	135	220	220	60	254	177	47	5.0	155267
125	125	284	320	135	240	240	80	296	201	49	5.2	155271
150	75	265	255	160	210	220	35	220	161	54	5.1	176785
150	100	287	295	160	240	240	55	262	185	54	5.8	155281
150	125	307	325	160	255	255	70	298	202	52	7.4	155282
150	150	323	355	160	265	265	90	333	219	53	7.9	155285
200	100	340	310	210	270	280	40	275	197	64	9.3	155291
200	125	360	340	210	285	295	55	310	215	62	11.6	155292
200	150	383	375	210	300	300	75	353	240	66	12.3	155293
200	200	418	455	210	340	340	115	428	280	68	17.1	155295
250	200	486	480	274	390	390	90	440	291	75	22.4	288077
250	250	537	560	274	430	430	130	529	335	70	29.0	288078
300	250	588	580	326	465	465	115	540	347	80	37.6	288079
300	300	634	660	326	505	505	155	661	431	115	46.3	288080

All dimensions are in mm and nominal weights are in kg

This document is provided for information purposes only and our company reserves the right to modify the information contained herein at any time. Our company declines all responsibility in the event of the use or installation of materials that do not comply with the rules prescribed in this document as well as with the standards, the technical documents and the applicable professional standards. Any orders placed will be subject to our General Terms and Conditions of Sale, available on request. The drawings and/or images are the exclusive property of Pam Building and are confidential. They must not be reproduced or disclosed to any third party without written consent. They may only be used for the purpose for which they were issued and are returnable on request.

Pam Building

130 Impasse du Chêne • 54700 BOUXIÈRES-SOUS-FROIDMONT • France • Tel: +33 (0) 3 66 88 19 47 • Email: tc@pambuilding.com • www.pambuilding.com
Simplified joint-stock company with a capital of 6,812,970.75€ • SIREN 799 283 882 • RCS NANCY