

PAM GLOBAL S

Short single branch 45°

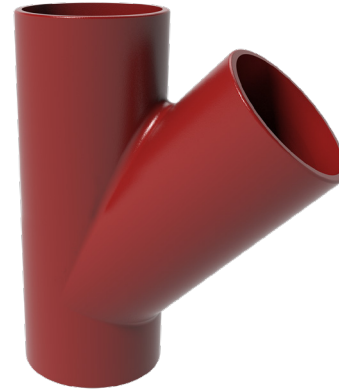

DESCRIPTION

Part of the standard range, the PAM GLOBAL S single branch allows the junction between two pipe runs at a 45° angle for conveying fluid waste or rainwater. The cast iron fittings are coated with a reddish-brown epoxy film applied by cathodolysis and are fully and indefinitely recyclable.

RECOMMENDED USE

- Rainwater
- Valve water
- Wastewater

STANDARDS & APPROVALS

- Industry Product Standards: EN 877, CE, DIN 19522, GEG RAL-GZ 698
- Range acoustic performance: $L_{sc,A} < 10$ dB(A) & $L_{a,A} = 47$ dB(A) according to EN 14366 with 2 l/s.
- Range reaction to fire: Euroclass A1

Material & Coatings

- Cast Iron
- Coating: red-brown, anti-corrosive cathodolysis epoxy, average dry film thickness 70 μ m.

TECHNICAL FEATURES

- Hot water resistance: 24h at 95°C.
- Thermal cycle resistance: 1500 cycles between 15°C and 93°C.
- Chemical resistance for $2 \leq \text{pH} \leq 12$.
- Salt spray resistance internal coating: more than 350 h.

ENVIRONMENTAL DATA

- Percentage of Recycled Content: 99.0 %
- Recycling Information: Cast iron is fully recyclable through the existing recycling industrial network.
Data source: Environmental Product Declaration S-P-02013



999999
PAM GLOBAL® S
Sample fitting



PAM GLOBAL S

Short single branch 45°

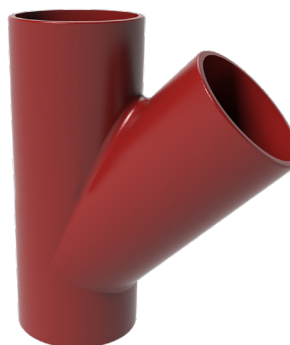
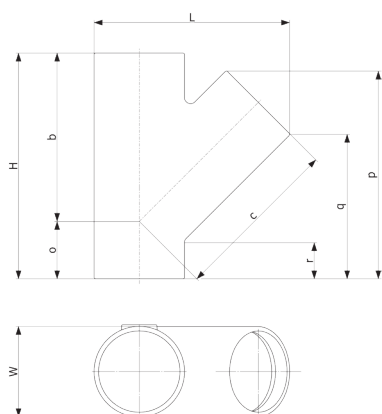

DN	dn	L	H	W	b	c	o	p	q	r	Weight	Product Code
50	50	144	185	58	135	135	50	165	124	36	1.35	155769
75	50	156	180	83	135	135	45	161	120	43	1.6	173786
75	75	179	215	83	155	155	60	198	140	40	2.2	173787
100	50	191	200	110	165	165	35	172	131	47	2.4	155828
100	75	214	235	110	185	185	50	209	150	44	3.2	173788
100	100	238	275	110	205	205	70	253	175	45	4.0	155857
125	50	218	205	135	185	185	20	170	130	44	3.2	155877
125	75	237	240	135	195	200	45	215	156	51	4.2	176716
125	100	261	280	135	220	220	60	254	177	47	5.0	155882
125	125	284	320	135	240	240	80	296	201	49	5.2	155895
150	75	265	255	160	210	220	35	220	161	54	5.1	176733
150	100	287	295	160	240	240	55	262	185	54	5.8	155912
150	125	307	325	160	255	255	70	298	202	52	7.4	155914
150	150	323	355	160	265	265	90	333	219	53	7.9	155926
200	75	303	260	210	240	240	20	218	159	64	7.4	176734
200	100	340	310	210	270	280	40	275	197	64	9.3	155935
200	125	360	340	210	285	295	55	310	215	62	11.6	155936
200	150	383	375	210	300	300	75	353	240	66	12.3	155937
200	200	418	455	210	340	340	115	428	280	68	17.1	155944
250	100	398	330	274	315	315	15	276	198	72	13.6	155949
250	125	420	370	274	335	335	35	318	223	75	17.8	155950
250	150	440	405	274	350	350	55	358	245	75	22.0	155951
250	200	486	480	274	390	390	90	440	291	75	22.4	155952
250	250	537	560	274	430	430	130	529	335	70	29.0	155956
300	100	445	350	326	345	345	5	287	208	88	18.9	155961
300	125	464	375	326	360	360	15	316	221	80	22.7	155962
300	150	487	415	326	380	380	35	359	246	81	28.0	155963
300	200	547	485	326	415	440	70	454	305	81	31.0	155964
300	250	588	580	326	465	465	115	540	347	80	37.6	155965
300	300	634	660	326	505	505	155	661	431	115	46.3	155968
400	300	728	660	429	555	565	105	618	388	86	56.4	288118
400	400	820	835	429	645	645	190	795	492	101	98.0	288119

All dimensions are in mm and nominal weights are in kg

This document is provided for information purposes only and our company reserves the right to modify the information contained herein at any time. Our company declines all responsibility in the event of the use or installation of materials that do not comply with the rules prescribed in this document as well as with the standards, the technical documents and the applicable professional standards. Any orders placed will be subject to our General Terms and Conditions of Sale, available on request. The drawings and/or images are the exclusive property of Pam Building and are confidential. They must not be reproduced or disclosed to any third party without written consent. They may only be used for the purpose for which they were issued and are returnable on request.

Pam Building

130 Impasse du Chêne • 54700 BOUXIÈRES-SOUS-FROIDMONT • France • Tel: +33 (0) 3 66 88 19 47 • Email: tc@pambuilding.com • www.pambuilding.com
Simplified joint-stock company with a capital of 6,812,970.75€ • SIREN 799 283 882 • RCS NANCY