

# PAM GLOBAL PLUS

## Branch trap DN 50 to DN150

### DESCRIPTION

The PAM GLOBAL PLUS branch trap are cast iron components which allows the conservation of a water trap preventing the rise of odours. The trap can be connected to either the horizontal or the vertical flow stream and directed in different directions by means of bends. The unused inlet is to be closed off with a blank end of socket plug. The trap is fitted with a cleaning plug at the base.

### RECOMMENDED USE

- Aggressive effluents
- Fat Wastewater
- Industrial Wastewater
- Corrosive atmosphere
- Hot effluents

### STANDARDS & APPROVALS

- Industry Product Standards:
  - NF EN877
- Acoustic Performance:  $L_{sc} \leq 10$  dB(A) &  $L_{aA} = 47$  dB(A) according to EN 14366 with 2L/s.
- Range fire classification: A2-s1,d0



### Material & Coatings

- Cast Iron
- Coating: grey RAL 7015, epoxy, average dry film thickness 300  $\mu$ m.

### TECHNICAL FEATURES

- Hot water resistance: 24h at 95°C.
- Thermal cycle resistance: 1500 cycles between 15°C and 93°C.
- Chemical resistance for  $1 \leq \text{pH} \leq 13$ , up to 80°C.
- Salt spray resistance: more than 2500h.

### STANDARDS & APPROVALS

- Percentage of Recycled Content: 99 %
  - Recycling Information: Cast iron is 100% recyclable through the existing recycling industrial network.
- Data source: Environmental Product Declaration S-P02014

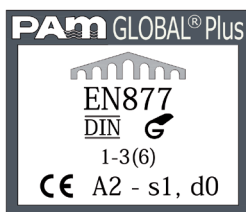

# PAM GLOBAL PLUS

## Branch trap DN 50 to DN150

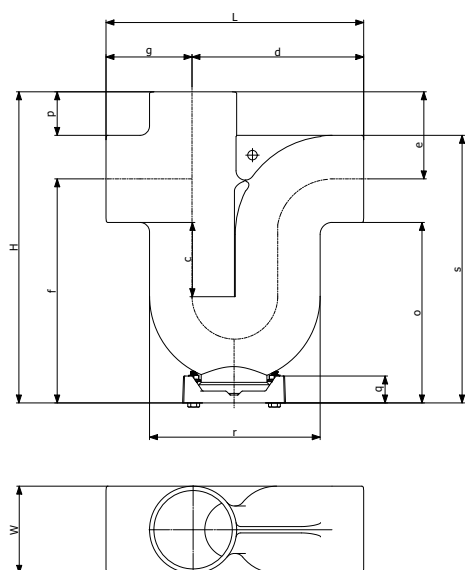

DN	L	H	W	c	d	e	f	g	o	p	q	r	s	Access (*)	Weight	Product code
50	190	240	58	60	182	68	122	68	143	39	33	112	201	EP 50	2.5	155311
75	274	282	80	60	200	93	172	93	150	52	13	162	230	TS 50	4.6	155334
100	325	381	110	100	282	110	215	110	216	55	15	216	326	TS 50	7.9	155372
125	390	435	134	100	316	130	260	130	238	63	12	266	372	TS 75	10.7	155404
150	470	482	160	100	348	145	325	145	257	65	8	340	417	TS 125	16.9	155436

All dimensions are in mm and nominal weights are in kg

(\*) with bottom cleaning access: EP by expansion plug / TS by tight sheet

Designed for rainwater networks. The arrows stamped on the cast iron body show the flow direction.

This document is provided for information purposes only and our company reserves the right to modify the information contained herein at any time. Our company declines all responsibility in the event of the use or installation of materials that do not comply with the rules prescribed in this document as well as with the standards, the technical documents and the applicable professional standards. Any orders placed will be subject to our General Terms and Conditions of Sale, available on request. The drawings and/or images are the exclusive property of Saint-Gobain PAM and are confidential. They must not be reproduced or disclosed to any third party without written consent. They may only be used for the purpose for which they were issued and are returnable on request.

**Saint-Gobain PAM Bâtiment**

21 avenue Camille Cavalier - BP 129 • 54705 • PONT-À-MOUSSON • France • Tel: +33 (0) 383 807 808 • Email: tcbatiment.sgpam@saint-gobain.com • www.pambuilding.com  
Société par action simplifiée au capital de 6 812 970,75€ • SIREN 799 283 882 • RCS NANCY