

ITINERO

Short radius bend 88°



DESCRIPTION

Part of the range dedicated to infrastructure, the Itinero 88° short radius bend allows a change of direction of the conveyed surface water. Designed for bridges and tunnels, the cast iron fittings are coated with a thick grey powder epoxy layer and are fully and indefinitely recyclable.

Material & Coatings

- Cast Iron
- Coating: mat grey RAL 7030, epoxy, average dry film thickness 300 µm.

RECOMMENDED USE

- Aggressive outdoor environment
- Buried networks
- Hydrocarbon Wastewater
- Runoff water

TECHNICAL FEATURES

- Hot water resistance: 24h at 95°C.
- Thermal cycle resistance: 1500 cycles between 15°C and 93°C.
- Chemical resistance for $2 \leq \text{pH} \leq 12$.
- Salt spray resistance: more than 4500 h.

STANDARDS & APPROVALS

- Industry Product Standards:
 - NF EN877
- Acoustic Performance: $L_{sc} \leq 10$ dB(A) & $L_{aA} = 47$ dB(A) according to EN 14366 with 2L/s.
- Range fire classification: A2-s1,d0

ENVIRONMENTAL DATA

- Percentage of Recycled Content: 99 %
- Recycling Information: Cast iron is 100% recyclable through the existing recycling industrial network. Data source: Declaration of recycled content.

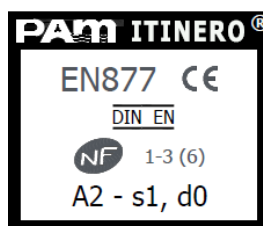

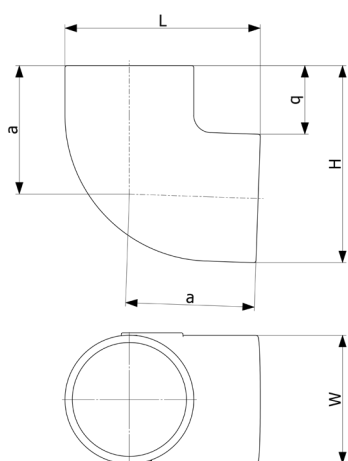

DN	L	H	W	a	q	Weight	Product Code
100	166	169	110	110	59	2.2	277905
125	194	197	135	125	62	2.9	277826
150	227	230	160	145	70	4.3	277879
200	288	291	210	180	81	8.1	277880
250	360	363	274	223	89	13.5	277881
300	427	431	326	280	105	27.7	277882
400	644	651	429	466	223	59	277896

All dimensions are in mm and nominal weights are in kg

This document is provided for information purposes only and our company reserves the right to modify the information contained herein at any time. Our company declines all responsibility in the event of the use or installation of materials that do not comply with the rules prescribed in this document as well as with the standards, the technical documents and the applicable professional standards. Any orders placed will be subject to our General Terms and Conditions of Sale, available on request. The drawings and/or images are the exclusive property of Saint-Gobain PAM and are confidential. They must not be reproduced or disclosed to any third party without written consent. They may only be used for the purpose for which they were issued and are returnable on request.